

DUNA CC

320RA01C11

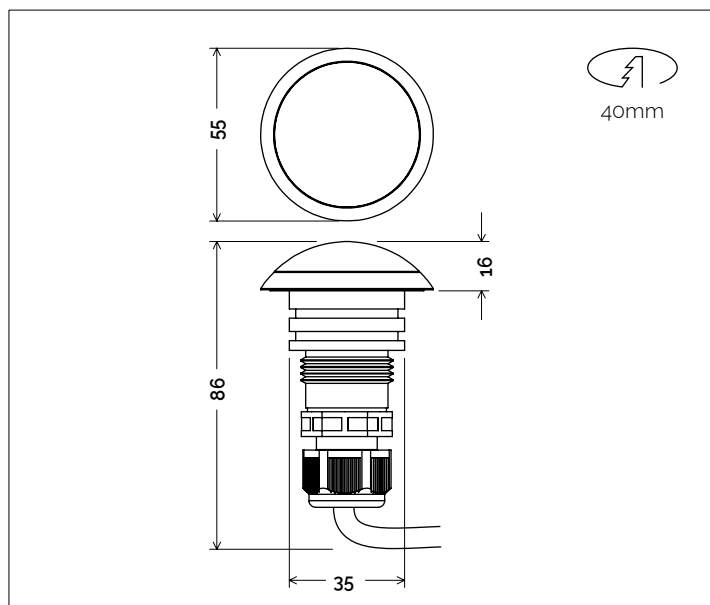

Descrizione del prodotto / Product description

Incasso LED per interni ed esterni.

Corpo realizzato in tornitura di alluminio con trattamento superficiale di anodizzazione nera.

Flangia superiore in Acciaio Inox AISI316L o Bronzo Naturale.

Ottica ad emissione spot in PMMA trasparente.

Lente superiore tornito in PMMA trasparente.

Pressacavo posteriore IP68.

Power LED di potenza ad altissima efficienza CRI ≥90.

Cavo di collegamento in neoprene. Fornito con sistema di connessione rapida termoretraibile (vedi istruzioni di montaggio).

LED projector for indoor / outdoor.

Body made of turning aluminum with black anodized treatment.

Upper flange made of Stainless Steel AISI316L or Natural Bronze.

Spot optics made of clear PMMA.

Upper lens made of turned clear PMMA.

Rear co-printed cable gland IP68.

Power LED with very high efficiency CRI ≥90.

Neoprene connection cable. Supplied with heat shrink fast connection system (see assembly instructions)

Dati tecnici | Technical Info

* su richiesta / on requests

| | |
|---|--|
| Finiture Finishes | 1002 Acciaio Inox AISI 316L Satin Stainless Steel AISI316L |
| | 1012 Bronzo Naturale Natural Bronze |
| | Verniciati RAL RAL Paintings* |
| | |
| Potenza Power | 3W |
| Corrente Current | 700mA |
| Tensione Voltage | 2 ~ 3V |
| Tolleranza cromatica Chromatic tolerance | 3 SDCM |
| Flusso luminoso Luminous Flux | 236lm |
| Mantenimento del flusso luminoso Flux Maintenance | ≥50.000h |
| Temperature di esercizio Operating temperature | -20° ~ 45° |

Simbologia tecnica Technical informations

| | |
|--|--------------------------------|
| | Conforme alle direttive CE |
| | Conforme alle normative RoHS |
| | Classe III |
| | Indice di Protezione IP65 |
| | Connettore stagno in dotazione |

Temperatura di Colore Color Temperature

| |
|---------------------|
| 9027 - 2700K CRI 92 |
| 9030 - 3000K CRI 92 |
| 9040 - 4000K CRI 92 |

Ottiche Optics

| | |
|--|-------------------------------|
| | N1 -8° (Very Narrow Beam) |
| | N4 -15° (Narrow Beam) |
| | F1 -30° (Flood Beam) |
| | W1 -45° (Wide Flood Beam) |
| | E1 -15°x45° (Elliptical Beam) |

Sistemi di Controllo Control System

| | |
|--|---|
| | On / Off (remoto escluso / remote excluded) |
| | PUSH Push * (remoto escluso / remote excluded) |
| | 1-10V 1-10V, 0-10V * (remoto escluso / remote excluded) |
| | DALI * (remoto escluso / remote excluded) |

Creazione Codice | Code construction

320RA01C11-XXXX-XX-XXXX

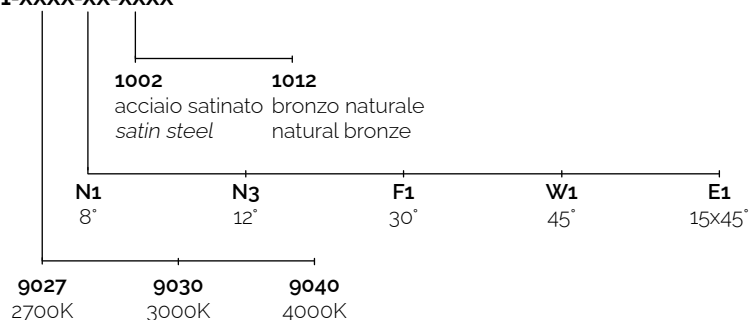

Dati Fotometrici | Photometric Specification

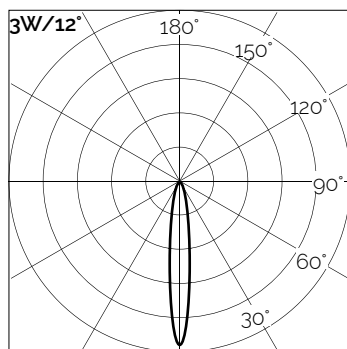

| h (m) | E (lx) | D (cm) |
|-------|--------|--------|
| 1 | 2660 | 21 |
| 1.5 | 1134 | 31 |
| 2 | 695 | 42 |
| 2.5 | 425 | 52 |
| 3 | 303 | 63 |

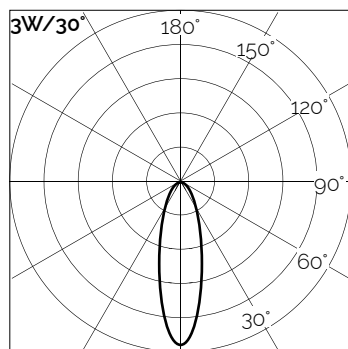

| h (m) | E (lx) | D (cm) |
|-------|--------|--------|
| 1 | 646 | 53 |
| 1.5 | 285 | 80 |
| 2 | 160 | 107 |
| 2.5 | 103 | 133 |
| 3 | 71 | 160 |

Accessori | Accessories

9A001

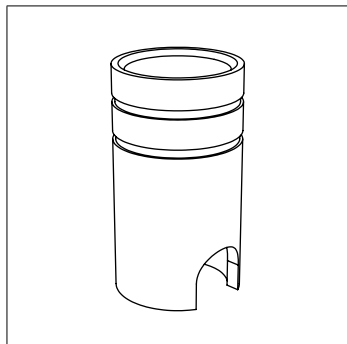

Cassaforma per incasso
(Ø44mm H.80mm)

Recessed Box
(Ø44mm H.80mm)

9A002

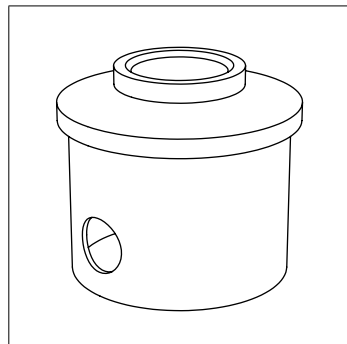

Cassaforma maggiorata per
incasso
(Ø90mm H.80mm)

Large Recessed Box
(Ø90mm H.80mm)

9A003

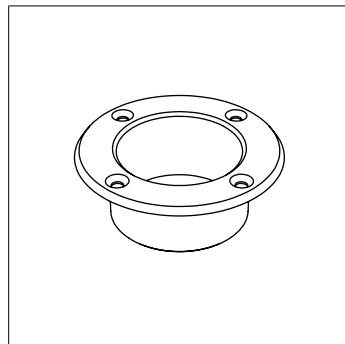

Cassaforma per pannello.
foro Ø42mm (flangia Ø58,8 x
22mm)

Recessed Box for panel
hole Ø42mm(Ø58,8 x 22mm)

9F005

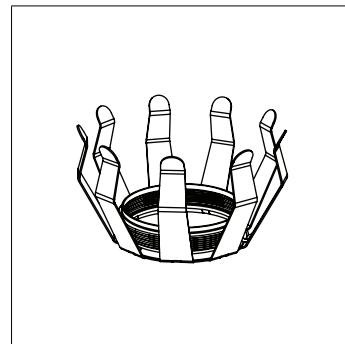

Molla di fissaggio.
(foro su pannello Ø40mm)

Fixing Spring.
(hole on panel Ø40mm)

Alimentatori | *Led*

| Tipo Alim. / Driver Type | potenza / power | corrente / current | dimensioni / dimensions | n. prodotti | IP | codice / code |
|--------------------------|-----------------|--------------------|-------------------------|-------------|----|---------------|
| ON/OFF | 10W | 700mA | 39x22x75mm | 1 ~ 3 | 20 | 9M109 |
| | 14W | 700mA | 38x25x79mm | 1 ~ 5 | 67 | 9M203 |
| DALI | 23W | 700mA | 47x26x111mm | 1 ~ 15 | 67 | 9M602/700 |